

Header & Socket Connectors

2-169~2-172 • PCB Conn. 5.08mm

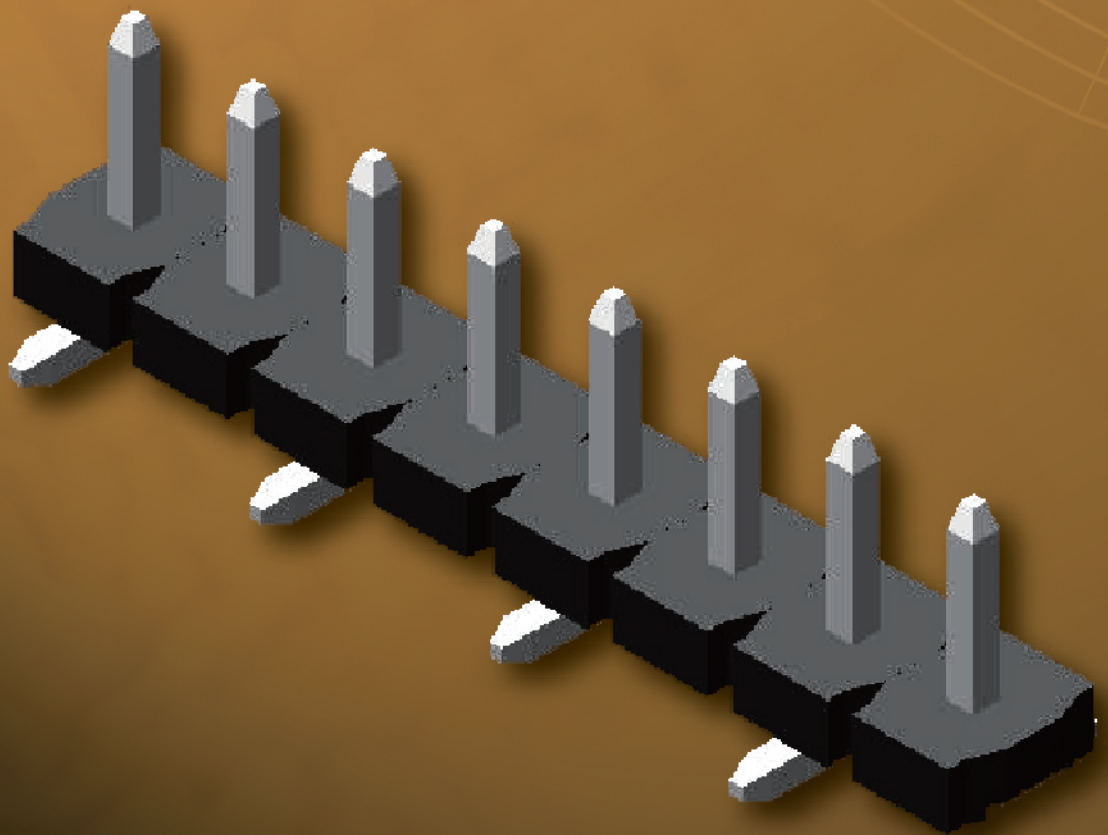

AMTEK Technology Co., Ltd



Pin Header 5.08mm 1 Row H=2.5mm SMT Type

Specifications

Current Rating: 7 AMP
 Insulation Resistance: 1000MΩ Min.
 Contact Resistance: 20mΩ Max.
 Dielectric Voltage: 500V AC for one minute

Material

Insulator: Polyester, UL 94V-0
 Standard: LCP
 Terminal: Copper Alloy
 Standard Plating: Tin Plated

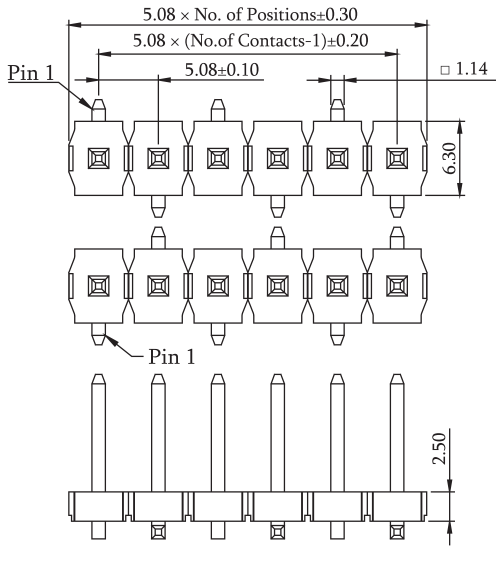

A Type

B Type

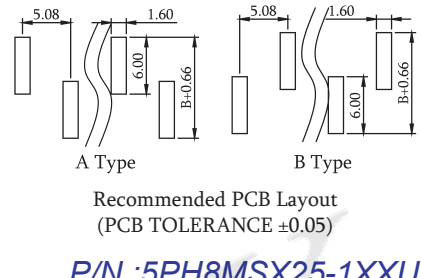

P/N.: 5PH8MSX25-1XXU

Pin Header 5.08mm 1 Row H=2.5mm Stack SMT Type

Specifications

Current Rating: 7 AMP
 Insulation Resistance: 1000MΩ Min.
 Contact Resistance: 20mΩ Max.
 Dielectric Voltage: 500V AC for one minute

Material

Insulator: Polyester, UL 94V-0
 Standard: LCP
 Terminal: Copper Alloy
 Standard Plating: Tin Plated

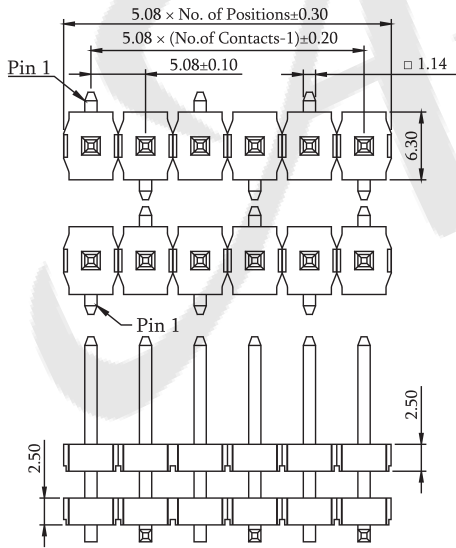

A Type

B Type

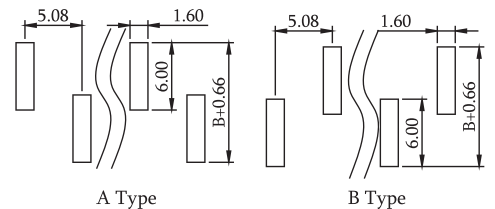

Recommended PCB Layout
 (PCB TOLERANCE ± 0.05)

P/N.: 5PH8DMX25-1XXU

ORDER INFORMATION

5	P	H	8	X	X	X	2	5	-	1	X	X	X	X	N	X	B	U	-	A/B/C			
MS: Single Plastic SMT DM: Stack Plastic SMT							Plastic Height 25: H=2.5mm		1: Single Row			No. of Contacts Per Row (02 ~ 20)				A: A Type B: B Type		B: Bag		A/L1/B			
G0: Gold Flash GA: Au 5u" GB: Au 10u" GC: Au 20u" GD: Au 30u" T0: Tin Plated															S0: Selective Au SA: Selective Au 5u" SB: Selective Au 10u" SC: Selective Au 20u" SD: Selective Au 30u" TE: Tin 200u"					U: RoHS + Hi-Temp		EX.: 040100030 A: 4.00(040) B/L1: 10.0(100) C/B: 3.00(030) A/B/C For Single Plastic Type A/L1/B For Stack Plastic Type	

Standard Recommended
 Tube package is not available for under 1*5 & 2*5 pin counts
 The option in the catalog for reference only, please contact with Amtek for more details.

Old P/N: PH8M/DM25-1

Pin Header 5.08mm

ROHS

Pin Header 5.08mm 1 Row H=2.5mm Right Angle Type

Specifications

Current Rating: 7 AMP
 Insulation Resistance: 1000MΩ Min.
 Contact Resistance: 20mΩ Max.
 Dielectric Voltage: 500V AC for one minute

Material

Insulator: Polyester, UL 94V-0
 Standard: LCP
 Terminal: Copper Alloy
 Standard Plating: Tin Plated

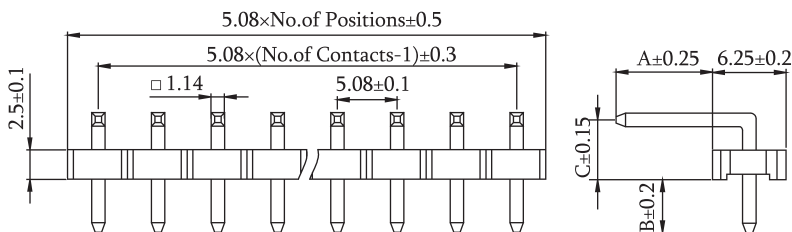

P/N.:5PH8RUX25-1XXU

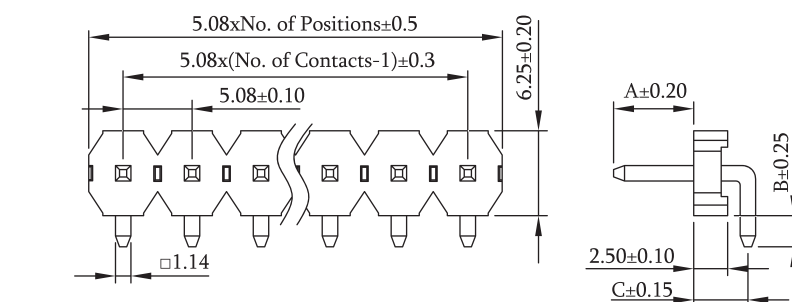

P/N.:5PH8RDX25-1XXU

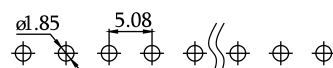

Recommended PCB Layout
 (PCB TOLERANCE ±0.05)

Pin Header 5.08mm 1 Row H=3.5mm Right Angle Type

Specifications

Current Rating: 7 AMP
 Insulation Resistance: 1000MΩ Min.
 Contact Resistance: 20mΩ Max.
 Dielectric Voltage: 500V AC for one minute

Material

Insulator: Polyester, UL 94V-0
 Standard: LCP
 Terminal: Copper Alloy
 Standard Plating: Tin Plated

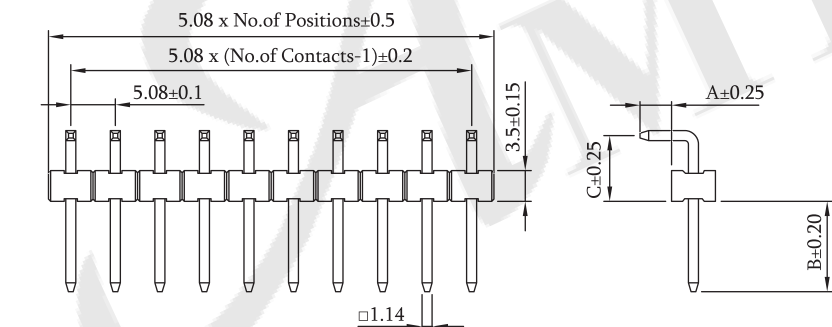

P/N.:5PH8RUX35-1XXU

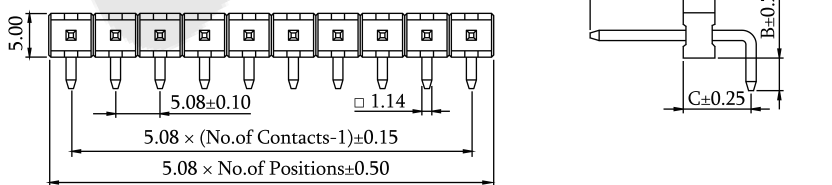

P/N.:5PH8RDX35-1XXU

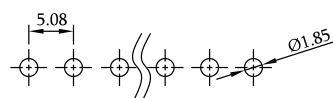

Recommended PCB Layout
 (PCB TOLERANCE ±0.05)

ORDER INFORMATION

5 P H 8 X X X X X - 1 X X X X N N B U - A/B/C

RU:R/A U Type
 RD:R/A Dip

Plastic Height
 25:H=2.5mm
 35:H=3.5mm

1:Single Row

No. of Contacts
 Per Row (02~20)

N:W/O Peg

B:Bag

U:RoHS + Hi-Temp

EX.:082045057
 A:8.15(082)
 B:4.45(045)
 C:5.73(057)

G0:Gold Flash	S0>Selective Au
GA:Au 5u"	SA>Selective Au 5u"
GB:Au 10u"	SB>Selective Au 10u"
GC:Au 20u"	SC>Selective Au 20u"
GD:Au 30u"	SD>Selective Au 30u"
T0:Tin Plated	TE:Tin 200u"

©:Standard Recommended
 Tube package is not available for under 1*5 & 2*5 pin counts
 The option in the catalog for reference only, please contact with Amtek for more details.

Old P/N:PH8RU25-1
 PH8R35-1



Pin Header 5.08mm

ROHS

Pin Header 5.08mm 1 Row H=2.5mm Straight Type

Specifications

Current Rating: 7 AMP
 Insulation Resistance: 1000MΩ Min.
 Contact Resistance: 20mΩ Max.
 Dielectric Voltage: 500V AC for one minute

Material

Insulator: Polyester, UL 94V-0
 Standard: LCP
 Terminal: Copper Alloy
 Standard Plating: Tin Plated

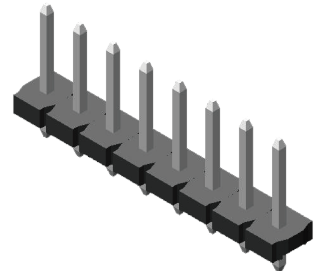
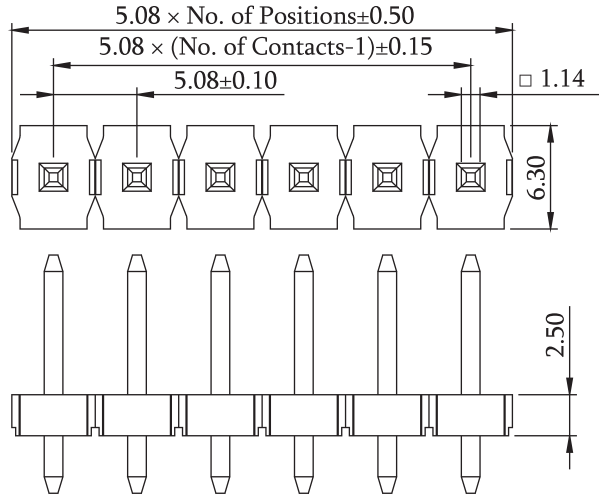

P/N.:5PH8SDX25-1XXU

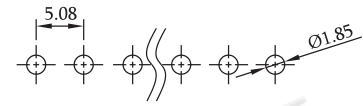

Recommended PCB Layout
 (PCB TOLERANCE ±0.05)

Pin Header 5.08mm 1 Row H=2.5mm Stack Straight Type

Specifications

Current Rating: 7 AMP
 Insulation Resistance: 1000MΩ Min.
 Contact Resistance: 20mΩ Max.
 Dielectric Voltage: 500V AC for one minute

Material

Insulator: Polyester, UL 94V-0
 Standard: LCP
 Terminal: Copper Alloy
 Standard Plating: Tin Plated

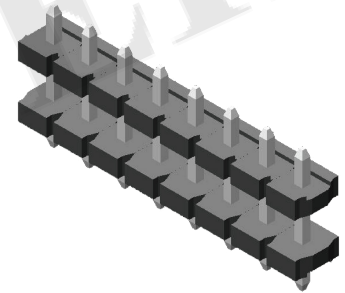
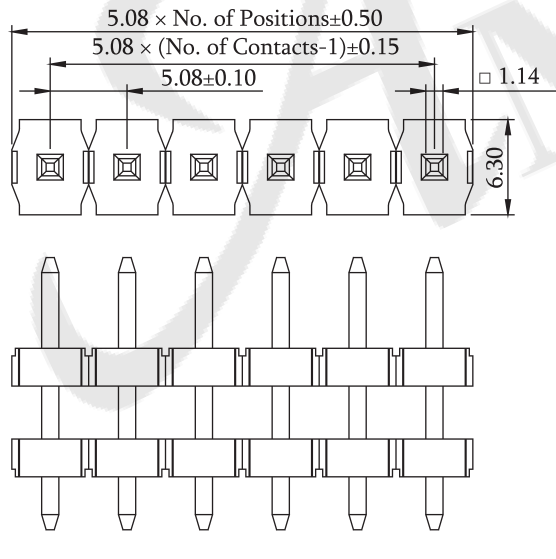

P/N.:5PH8DDX25-1XXU

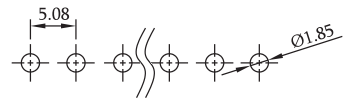

Recommended PCB Layout
 (PCB TOLERANCE ±0.05)

ORDER INFORMATION

5	P	H	8	X	X	X	2	5	-	1	X	X	X	X	N	N	X	X	-	A/B
SD: Single Plastic DIP DD: Stack Plastic DIP							Plastic Height 25:H=2.5mm			No. of Contacts Per Row (02~20)		N:W/O Peg					B: Bag		A/L1/B	
2: Dual Row										G0: Gold Flash		S0: Selective Au								
GA: Au 5u"		SA: Selective Au 5u"		GB: Au 10u"		SB: Selective Au 10u"		GC: Au 20u"		SC: Selective Au 20u"		GD: Au 30u"		SD: Selective Au 30u"		TE: Tin 200u"		EX.: 082045057 A: 8.15(082) B/L1: 4.45(045) C/B: 5.73(057) A/B For DIP Type Only A/L1/B For Stack Type Only		
U: RoHS + Hi-Temp																				

Ⓞ: Standard Recommended
 Tube package is not available for under 1*5 & 2*5 pin counts
 The option in the catalog for reference only, please contact with Amtek for more details.

Old P/N: PH8S25-1
 PH8D25-1

Female Header 5.08mm 1 Row H=8.9mm SMT Type

Specifications

Current Rating: 7 AMP
 Insulation Resistance: 1000MΩ Min.
 Contact Resistance: 20mΩ Max.
 Dielectric Voltage: 500V AC for one minute

Material

Insulator: Polyester, UL 94V-0
 Standard: LCP
 Terminal: Copper Alloy
 Standard Plating: Tin Plated

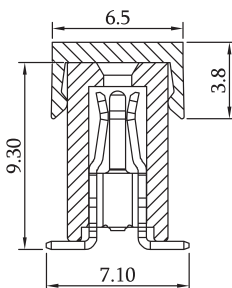
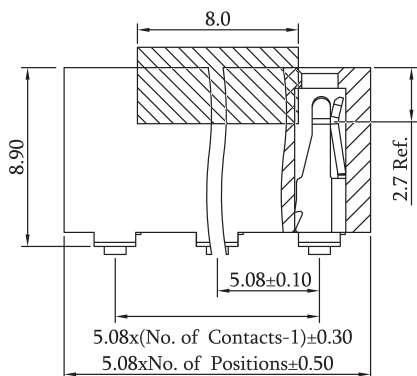
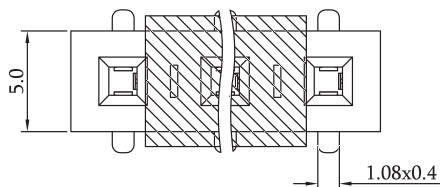
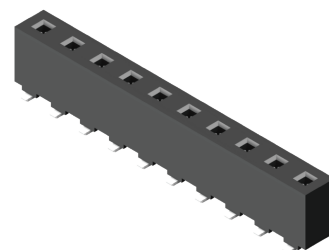

P/N.:5PS8MSC89-1XXU

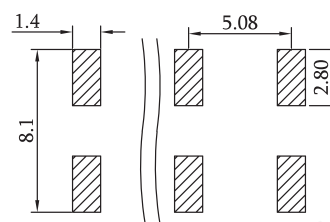

Recommended PCB Layout
 (PCB TOLERANCE ±0.05)

Female Header 5.08mm 1 Row H=8.9mm Straight Type

Specifications

Current Rating: 7 AMP
 Insulation Resistance: 1000MΩ Min.
 Contact Resistance: 20mΩ Max.
 Dielectric Voltage: 500V AC for one minute

Material

Insulator: Polyester, UL 94V-0
 Standard: LCP
 Terminal: Copper Alloy
 Standard Plating: Tin Plated

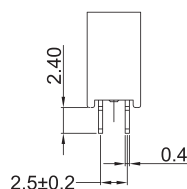
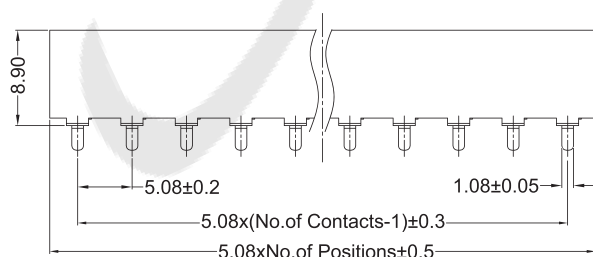
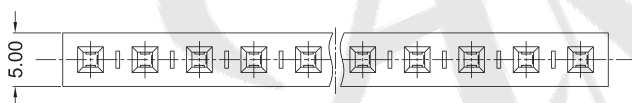
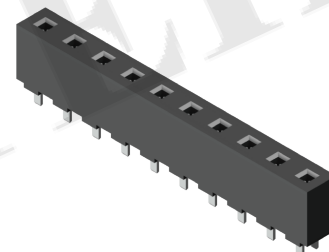

P/N.:5PS8SDA89-1XXP

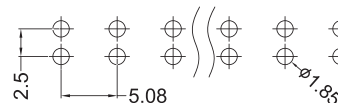

Recommended PCB Layout
 (PCB TOLERANCE ±0.05)

ORDER INFORMATION

5	P	S	8	X	X	X	8	9	-	X	X	X	X	N	N	N	X	X		
MS:SMT Straight SD: Straight DIP			Plastic Height 89:H=8.9mm			No. of Contacts Per Row (02~20)			1: Single Row			N:W/O Bump			N:W/O Peg			T: Tube W/O Cap C: Tube With Cap H: T/R W/O Cap R: T/R With Cap		
G0: Gold Flash			S0: Selective Au			N: Non Type			U: RoHS + Hi-Temp			GA: Au 5u"			SA: Selective Au 5u"			P: RoHS + LCP		
GB: Au 10u"			SB: Selective Au 10u"			GC: Au 20u"			SC: Selective Au 20u"			GD: Au 30u"			SD: Selective Au 30u"			TE: Tin 200u"		
T0: Tin Plated																				

©: Standard Recommended
 Tube package is not available for under 1*5 & 2*5 pin counts
 The option in the catalog for reference only, please contact with Amtek for more details.

Old P/N: PS8M89-1
 PS8S89-1