

# Header & Socket Connectors

---

2-167-2-168

• PCB Conn. 4.2mm

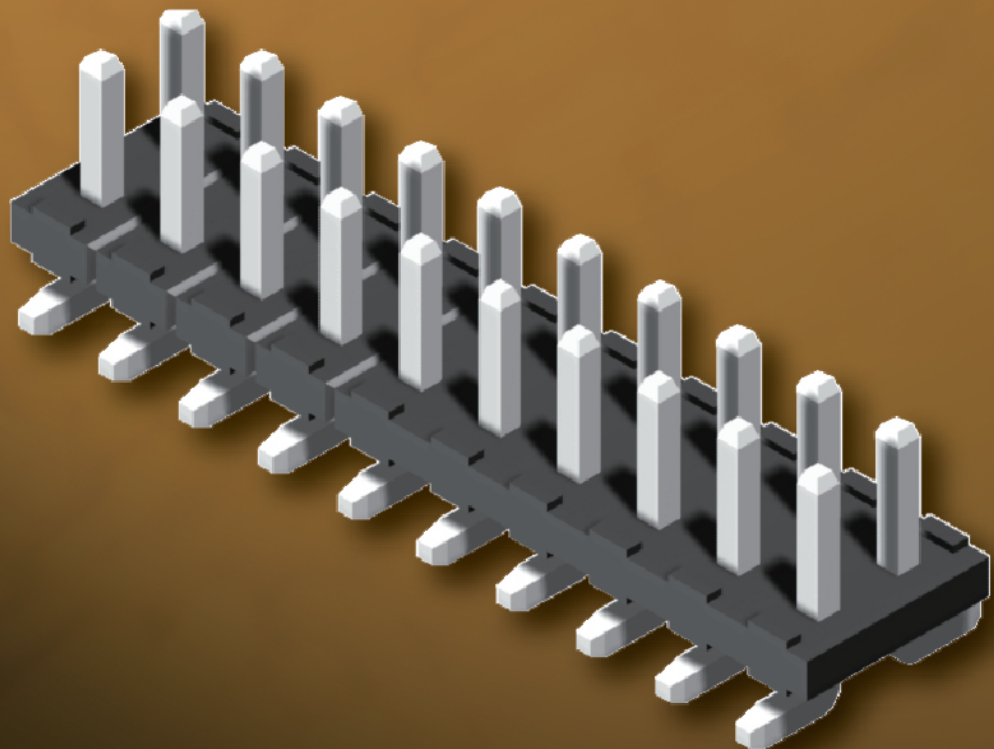

**AMTEK Technology Co., Ltd**



## Pin Header 4.2mm 1 Row H=2.5mm SMT R/A Type

### Specifications

Current Rating: 7 AMP  
 Insulation Resistance: 1000MΩ Min.  
 Contact Resistance: 20mΩ Max.  
 Dielectric Voltage: 500V AC for one minute

### Material

Insulator: Polyester, UL 94V-0  
 Standard: LCP  
 Terminal: Copper Alloy  
 Standard Plating: Tin Plated

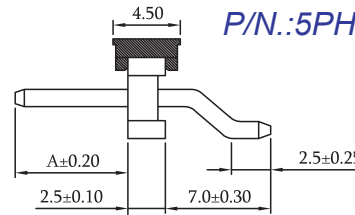
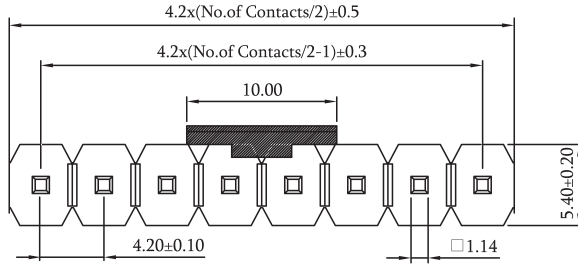
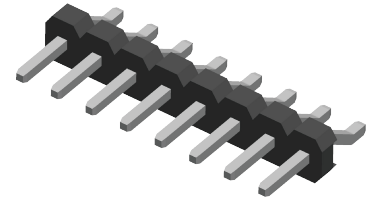

P/N.:5PHAMRA25-1XXU

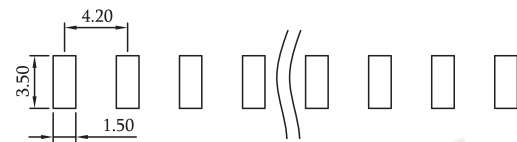

Recommended PCB Layout  
 (PCB TOLERANCE ±0.05)

## Pin Header 4.2mm 2 Row H=2.5mm Right Angle Type

### Specifications

Current Rating: 7 AMP  
 Insulation Resistance: 1000MΩ Min.  
 Contact Resistance: 20mΩ Max.  
 Dielectric Voltage: 500V AC for one minute

### Material

Insulator: Polyester, UL 94V-0  
 Standard: LCP  
 Terminal: Copper Alloy  
 Standard Plating: Tin Plated

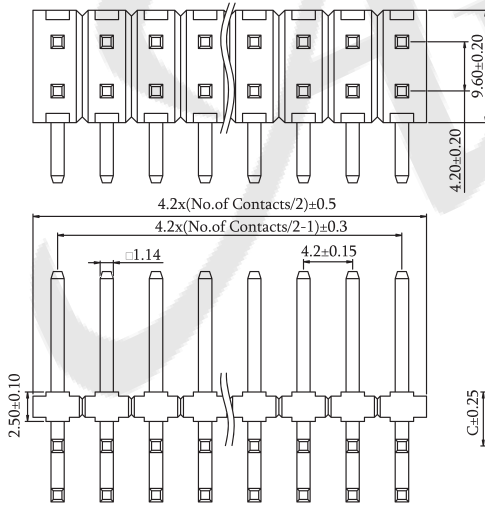
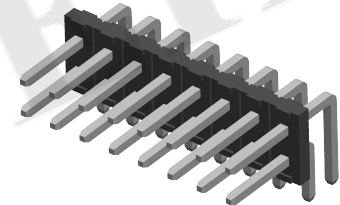

P/N.:5PHARDA25-2XXU

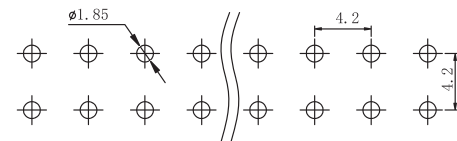

Recommended PCB Layout  
 (PCB TOLERANCE ±0.05)

## ORDER INFORMATION

5	P	H	A	X	X	X	2	5	-	X	X	X	X	N	N	X	U	-	A/B/C
MR:R/A SMT RD:R/A DIP						Plastic Height 25:H=2.5mm				No. of Contacts Per Row (02~20) For SD Only Per Row (02~40) For DD Only			N:W/O Peg		N:Non Type		U:RoHS + Hi-Temp		EX.:060030039 A:6.0(060) B:3.0(030) C:3.9(039)
1:Single Row 2: Dual Row		G0:Gold Flash GA: Au 5u" GB: Au 10u" GC: Au 20u" GD: Au 30u" T0: Tin Plated		S0: Selective Au SA: Selective Au 5u" SB: Selective Au 10u" SC: Selective Au 20u" SD: Selective Au 30u" TE: Tin 200u"		X:Box B:Bag R:T/R With Cap													

Ⓞ:Standard Recommended  
 Tube package is not available for under 1\*5 & 2\*5 pin counts  
 The option in the catalog for reference only, please contact with Amtek for more details.

P in Header 4.2mm

ROHS

## Pin Header 4.2mm 2 Row H=2.5mm SMT Type

### Specifications

Current Rating: 7 AMP  
 Insulation Resistance: 1000MΩ Min.  
 Contact Resistance: 20mΩ Max.  
 Dielectric Voltage: 500V AC for one minute

### Material

Insulator: Polyester, UL 94V-0  
 Standard SMT: LCP  
 Straight: Nylon 66  
 Terminal: Copper Alloy  
 Standard Plating: Tin Plated

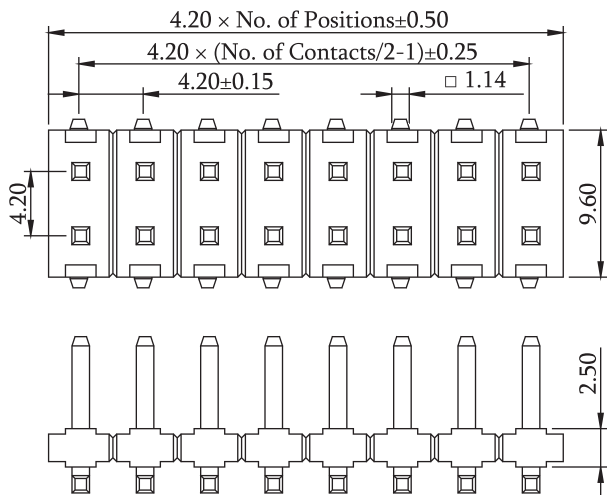
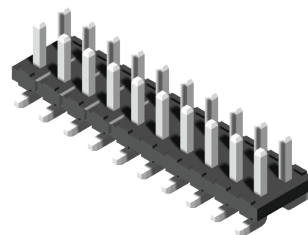

P/N.:5PHAMSX25-2XXU

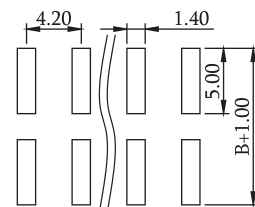
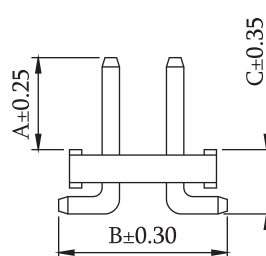

## Pin Header 4.2mm 2 Row H=2.5mm Straight Type

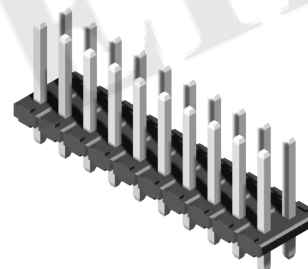
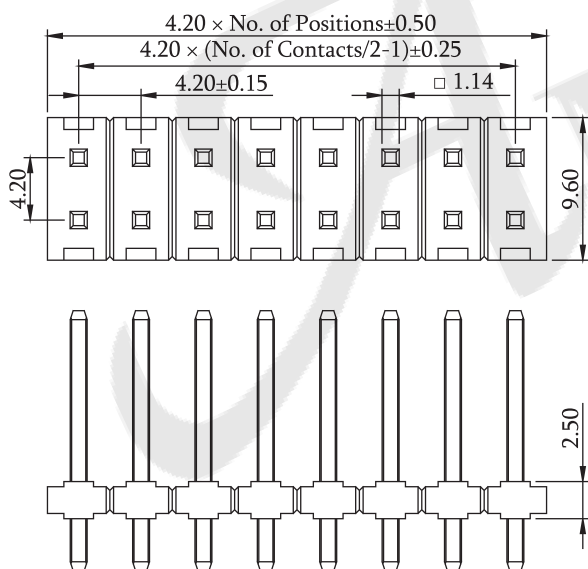

P/N.:5PHASDX25-2XXL

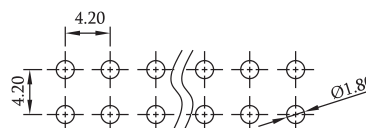
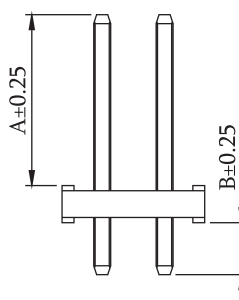

## ORDER INFORMATION

5 P H A X X X 2 5 - 2 X X X X N N X X - A/B/C

MS:SMT Straight  
 SD: Straight DIP

Plastic Height  
 25:H=2.5mm

No. of Contacts  
 Per Row (02~16)

N:W/O Peg

B: Bag  
 T: Tube W/O Cap  
 C: Tube With Cap  
 H: T/R W/O Cap  
 R: T/R With Cap  
 T/R For SMT Only

EX.:060110042  
 A:6.00(060)  
 B:11.00(110)  
 C:4.20(042)

2: Dual Row

GO: Gold Flash	SO: Selective Au
GA: Au 5u"	SA: Selective Au 5u"
GB: Au 10u"	SB: Selective Au 10u"
GC: Au 20u"	SC: Selective Au 20u"
GD: Au 30u"	SD: Selective Au 30u"
TO: Tin Plated	TE: Tin 200u"

U: RoHS + Hi-Temp  
 L: RoHS + PBT

©: Standard Recommended  
 Tube package is not available for under 1\*5 & 2\*5 pin counts  
 The option in the catalog for reference only, please contact with Amtek for more details.

Old P/N: PH42M25-2  
 PH42S25-2