

Header & Socket Connectors

2-163~2-166 • PCB Conn. 3.96mm

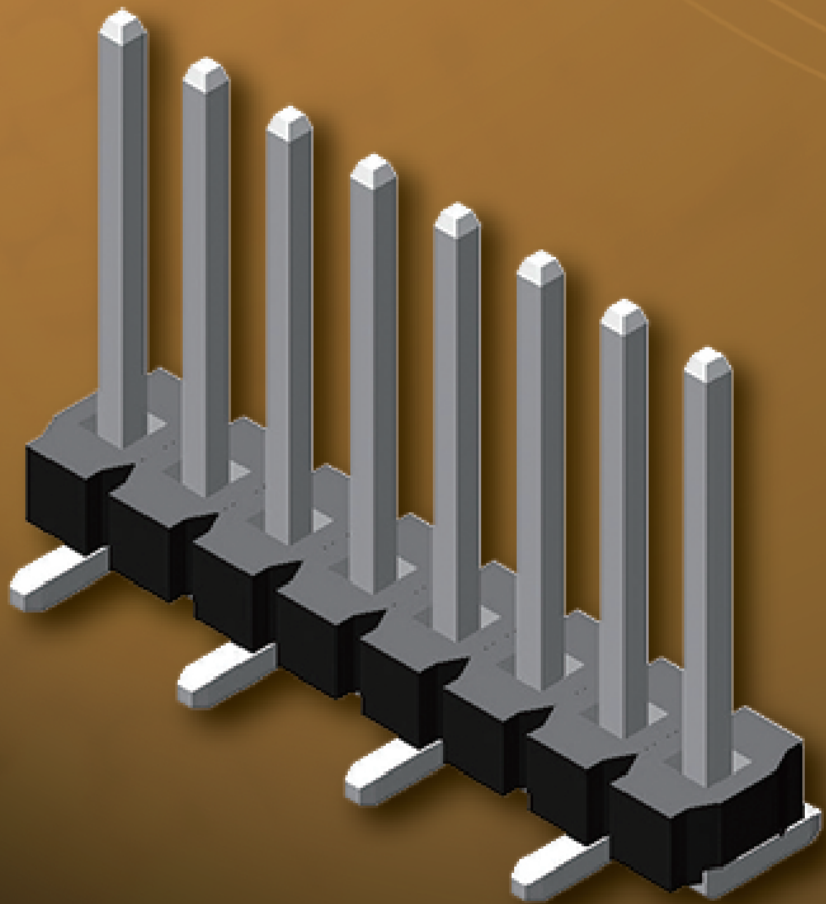

AMTEK Technology Co., Ltd

CONNECTORS MANUFACTURER



Pin Header 3.96mm 1 Row H=3.2mm SMT R/A Type

Specifications

Current Rating: 7 AMP
 Insulation Resistance: 1000MΩ Min.
 Contact Resistance: 20mΩ Max.
 Dielectric Voltage: 500V AC for one minute

Material

Insulator: Polyester, UL 94V-0
 Standard: LCP
 Terminal: Copper Alloy
 Standard Plating: Tin Plated

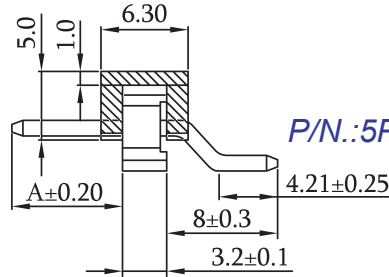
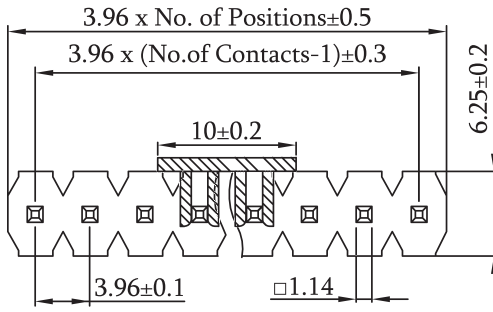
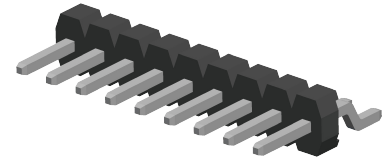

P/N.: 5PH9MRA32-1XXU

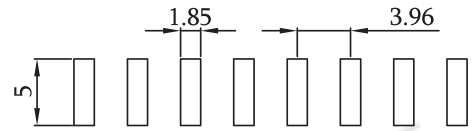

Recommended PCB Layout
 (PCB TOLERANCE ±0.05)

Pin Header 3.96mm 1 Row H=3.2mm SMT Type

Specifications

Current Rating: 7 AMP
 Insulation Resistance: 1000MΩ Min.
 Contact Resistance: 20mΩ Max.
 Dielectric Voltage: 500V AC for one minute

Material

Insulator: Polyester, UL 94V-0
 Standard: LCP
 Terminal: Copper Alloy
 Standard Plating: Tin Plated

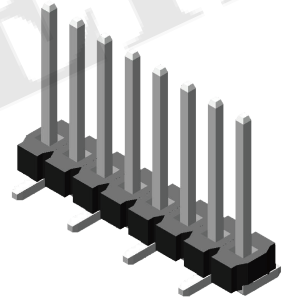
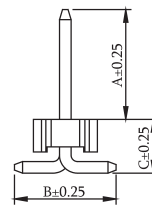
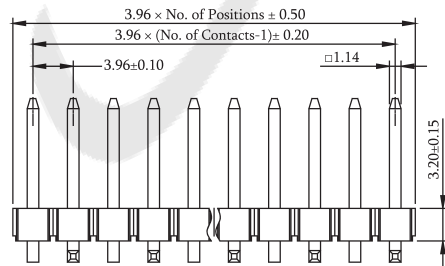
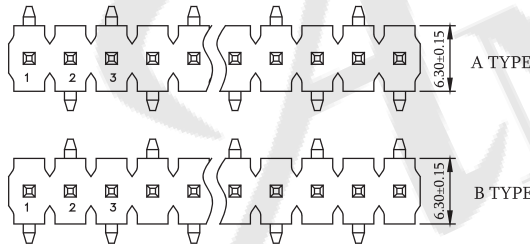

P/N.: 5PH9MSX32-1XXU

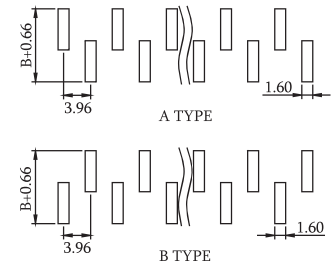

Recommended PCB Layout
 (PCB TOLERANCE ±0.05)

ORDER INFORMATION

5	P	H	9	X	X	X	3	2	-	1	X	X	X	X	N	X	X	U	-	A/B/C
MR: Single Plastic SMT R/A MS: Single Plastic SMT						Plastic Height 32:H=3.2mm		No. of Contacts Per Row (02~20)			N: Non Type For MR Only A: A Type B: B Type For MS Only		T: Tube W/O Cap C: Tube With Cap H: T/R W/O Cap R: T/R With Cap X: Box B: Bag		EX.: 060063040 A: 6.0(060) B: 6.3(063) C: 4.0(040)					
1: Single Row											N: W/O Peg		U: RoHS + Hi-Temp							
G0: Gold Flash				S0: Selective Au																
GA: Au 5u"				SA: Selective Au 5u"																
GB: Au 10u"				SB: Selective Au 10u"																
GC: Au 20u"				SC: Selective Au 20u"																
GD: Au 30u"				SD: Selective Au 30u"																
T0: Tin Plated				TE: Tin 200u"																

⊙: Standard Recommended
 Tube package is not available for under 1*5 & 2*5 pin counts
 The option in the catalog for reference only, please contact with Amtek for more details.

Old P/N: PH396MR32-1
 PH396M32-1

P in Header 3.96mm

ROHS

Pin Header 3.96mm 1 Row H=3.2mm Stack SMT Type

Specifications

Current Rating: 7 AMP
 Insulation Resistance: 1000MΩ Min.
 Contact Resistance: 20mΩ Max.
 Dielectric Voltage: 500V AC for one minute

Material

Insulator: Polyester, UL 94V-0
 Standard: LCP
 Terminal: Copper Alloy
 Standard Plating: Tin Plated

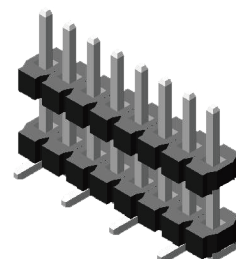
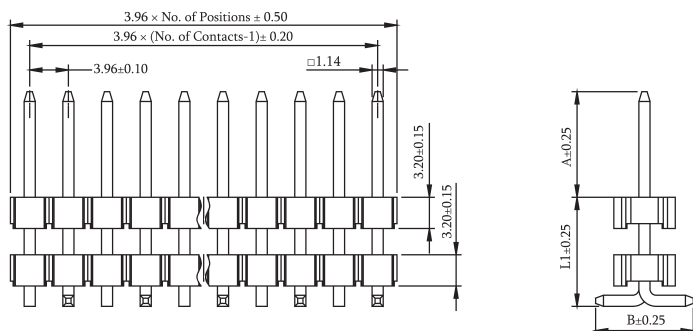
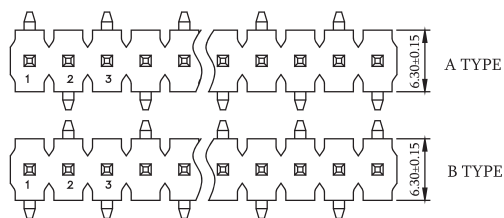

P/N.:5PH9DMX32-1XXU

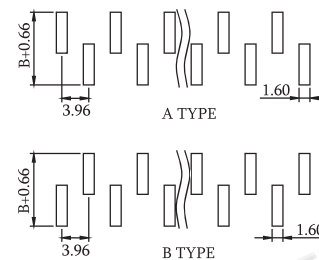

Recommended PCB Layout
 (PCB TOLERANCE ±0.05)

Pin Header 3.96mm 1 Row H=3.2mm Right Angle Type

Specifications

Current Rating: 7 AMP
 Insulation Resistance: 1000MΩ Min.
 Contact Resistance: 20mΩ Max.
 Dielectric Voltage: 500V AC for one minute

Material

Insulator: Polyester, UL 94V-0
 Standard: LCP
 Terminal: Copper Alloy
 Standard Plating: Tin Plated

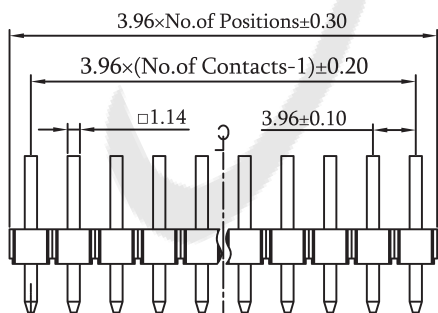
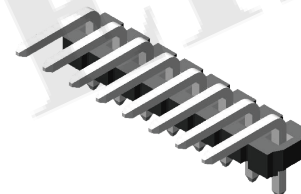

Lead Style	Dimensions		
	A	B	C
01	8.15	4.45	5.73
02	13.60	4.00	8.13
03	10.75	4.50	9.48

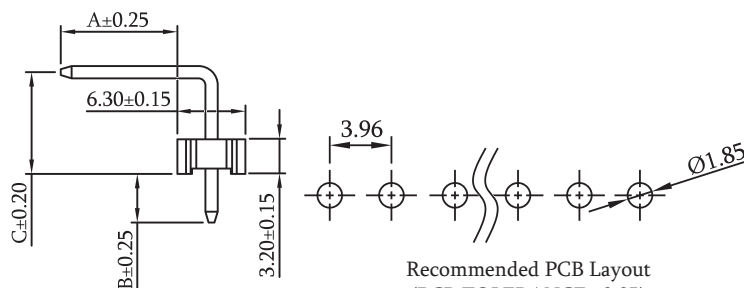

P/N.:5PH9RUX32-1XXU

Recommended PCB Layout
 (PCB TOLERANCE ±0.05)

ORDER INFORMATION

5 P H 9 X X X 3 2 - 1 X X X X X X U - A/L1/B A/B/C

DM: Stack Plastic SMT
 RU: Single Plastic R/A DIP

Plastic Height
 32: H=3.2mm

1: Single Row

No. of Contacts
 Per Row (01~20)
 For DM Only
 Per Row (01~24)
 For RU Only

N: W/O Peg
 P: With Peg
 For RU Only

A: A Type
 B: B Type
 For DM Only
 N: Non Type
 For RU Only

T: Tube W/O Cap
 C: Tube With Cap
 H: T/R W/O Cap
 R: T/R With Cap
 X: Box B: Bag

U: RoHS + Hi-Temp

EX.: 060067050
 A: 6.00(060)
 B/L1: 6.65(067)
 C/B: 5.00(050)
 A/L1/B For 5PH9DMX32
 A/B/C For 5PH9RUX32

G0: Gold Flash
 GA: Au 5u"
 GB: Au 10u"
 GC: Au 20u"
 GD: Au 30u"
 T0: Tin Plated

S0: Selective Au
 SA: Selective Au 5u"
 SB: Selective Au 10u"
 SC: Selective Au 20u"
 SD: Selective Au 30u"
 TE: Tin 200u"

©: Standard Recommended
 Tube package is not available for under 1*5 & 2*5 pin counts
 The option in the catalog for reference only, please contact with Amtek for more details.

Old P/N: PH396DM32-1
 PH396R32-1

CONNECTORS MANUFACTURER



Pin Header 3.96mm 1 Row H=3.2mm Straight Type

Specifications

Current Rating: 7 AMP
 Insulation Resistance: 1000MΩ Min.
 Contact Resistance: 20mΩ Max.
 Dielectric Voltage: 500V AC for one minute

Material

Insulator: Polyester, UL 94V-0
 Standard: LCP
 Terminal: Copper Alloy
 Standard Plating: Tin Plated

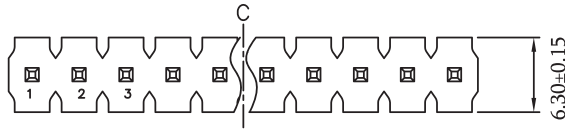

Lead Style	Dimensions	
	A	B
02	11.45	4.45
03	12.70	
04	20.55	4.00
05	3.80	12.10
06	11.45	3.20
13	10.80	3.50

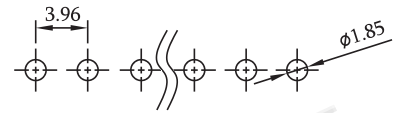
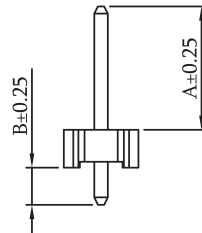
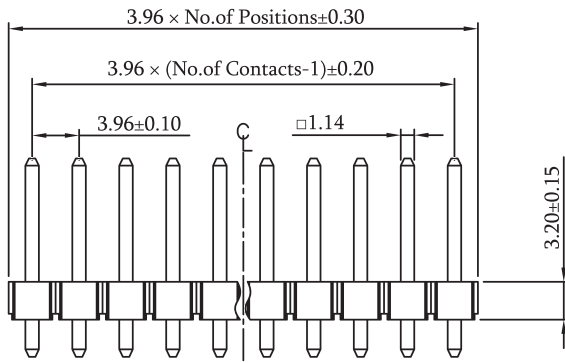
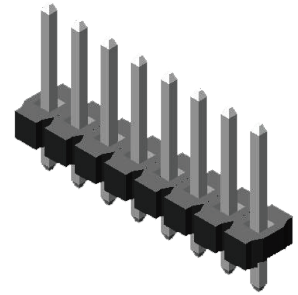

P/N.: 5PH9SDX32-1XXU

Recommended PCB Layout
(PCB TOLERANCE ±0.05)

Pin Header 3.96mm 1 Row H=3.2mm Stack Straight Type

Specifications

Current Rating: 7 AMP
 Insulation Resistance: 1000MΩ Min.
 Contact Resistance: 20mΩ Max.
 Dielectric Voltage: 500V AC for one minute

Material

Insulator: Polyester, UL 94V-0
 Standard: LCP
 Terminal: Copper Alloy
 Standard Plating: Tin Plated

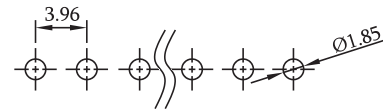
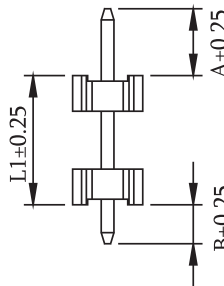
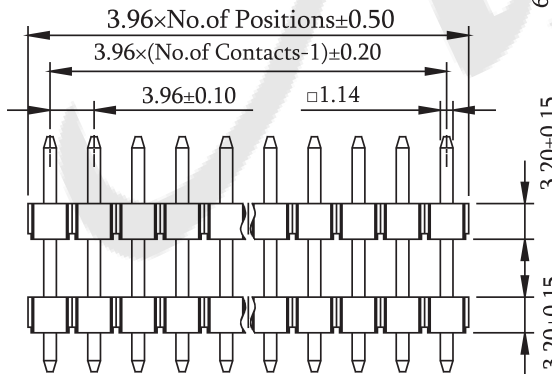

P/N.: 5PH9DDX32-1XXU

Recommended PCB Layout
(PCB TOLERANCE ±0.05)

ORDER INFORMATION

5	P	H	9	X	X	X	3	2	-	1	X	X	X	X	N	N	X	U	-	A/B	
SD: Single Plastic DIP DD: Stack Plastic DIP						Plastic Height 32: H=3.2mm		No. of Contacts Per Row (02~20)		1: Single Row	G0: Gold Flash GA: Au 5u" GB: Au 10u" GC: Au 20u" GD: Au 30u" T0: Tin Plated		S0: Selective Au SA: Selective Au 5u" SB: Selective Au 10u" SC: Selective Au 20u" SD: Selective Au 30u" TE: Tin 200u"		N: W/O Peg N: Non Type		T: Tube W/O Cap C: Tube With Cap H: T/R W/O Cap R: T/R With Cap X: Box B: Bag		U: RoHS + Hi-Temp		A/L1/B
EX.: 060040035 A: 6.00(060) B/L1: 4.00(040) C: 3.50(035) A/B/C For Single Plastic Type A/L1/B For Stack Plastic Type																					

⊙: Standard Recommended
 Tube package is not available for under 1*5 & 2*5 pin counts
 The option in the catalog for reference only, please contact with Amtek for more details.

Old P/N: PH396S32-1
 PH396D32-1

Pin Header 3.96mm

ROHS

F emale Header 3.96mm

Female Header 3.96mm 1 Row H=8.89mm SMT Type

Specifications

Current Rating: 7 AMP
 Insulation Resistance: 1000MΩ Min.
 Contact Resistance: 20mΩ Max.
 Dielectric Voltage: 500V AC for one minute

Material

Insulator: Polyester, UL 94V-0
 Standard: LCP
 Terminal: Copper Alloy
 Standard Plating: Tin Plated

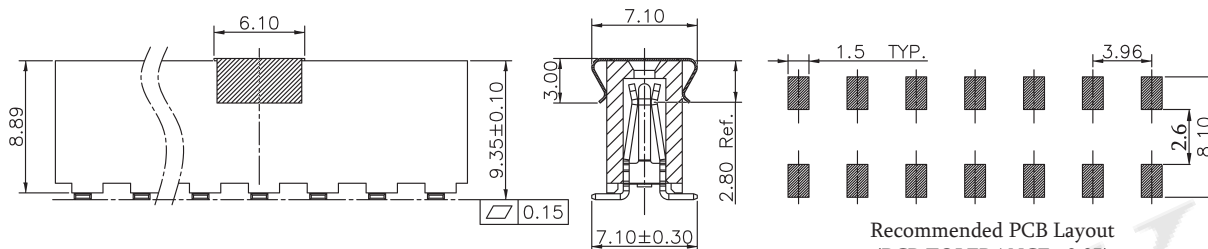
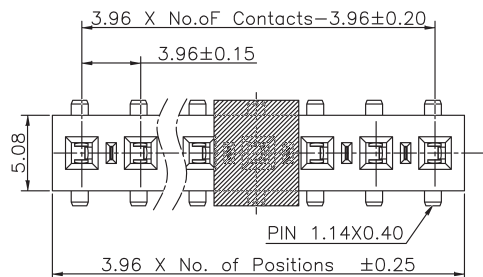
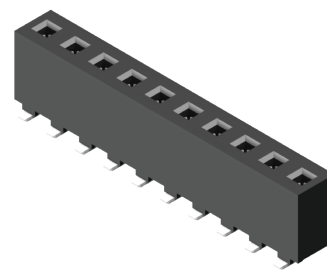

P/N.: 5PS9MSB89-1XXU

Recommended PCB Layout
 (PCB TOLERANCE ±0.05)

Female Header 3.96mm 1 Row H=8.89mm Straight Type

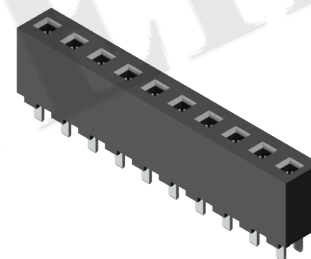
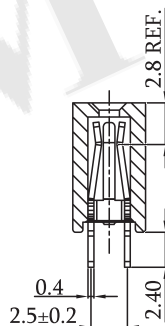
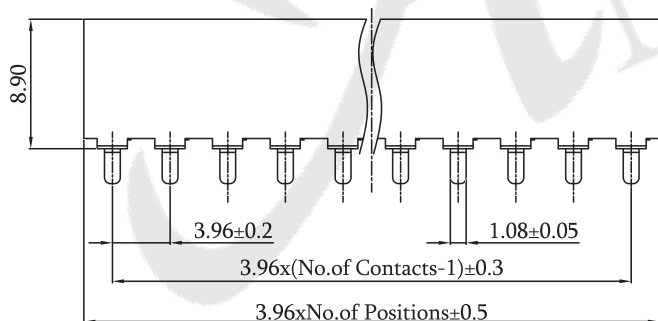
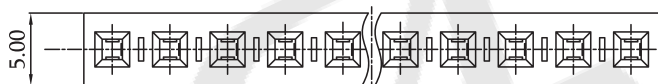

P/N.: 5PS9SDA89-1XXU



Recommended PCB Layout
 (PCB TOLERANCE ±0.05)

ORDER INFORMATION

5	P	S	9	X	X	X	8	9	-	1	X	X	X	X	N	N	N	X	U	
MS: SMT Straight SD: Straight DIP						Plastic Height 89: H=8.9mm			1: Single Row		No. of Contacts Per Row (02~24) For MS Only Per Row (02~20) For SD Only			N: W/O Bump		N: W/O Peg		T: Tube W/O Cap R: T/R With Cap X: Box		U: RoHS + Hi-Temp
						G0: Gold Flash			S0: Selective Au											
						GA: Au 5u"			SA: Selective Au 5u"											
						GB: Au 10u"			SB: Selective Au 10u"											
						GC: Au 20u"			SC: Selective Au 20u"											
						GD: Au 30u"			SD: Selective Au 30u"											
						T0: Tin Plated			TE: Tin 200u"											

©: Standard Recommended
 Tube package is not available for under 1*5 & 2*5 pin counts.
 The option in the catalog for reference only, please contact with Amtek for more details.

Old P/N: PS396M89-1
 PS396S-1